

SQR REFRIGERATED DISPLAY CASE



SQR 4848 W/STAINLESS STEEL SHELVES

- SQR 3 36"L.X30"D.X50"H.
- SQR 4 48"L.X30"D.X50"H.
- SQR 5 60"L.X30"D.X50"H.
- SQR 6 72"L.X30"D.X50"H.
- SQR 8 96"L.X30"D.X50"H.

STANDARD FEATURES

1. Top LED light.
2. Top glass.
3. Two (2) tempered glass shelves w/LED shelf lights.
4. Stainless steel inlay pan.
6. Thermo-pane rear sliding glass doors.
7. Standard high pressure laminate - Black.
8. Self contained condensing unit.

OPTIONS

- Exterior plastic laminate of choice.
- Stainless steel shelves.
- Powder coated metal components.
- Custom units on request.
- Solid side gables with mirrored interiors.
- Remote condensing unit.

MODEL	DIMENSIONS	H.P.	ELECTRICAL	SHIPPING WT.
SQR 3	36"L.X30"D.X50"H.	1/3 H.P.	115V/1/60HZ/ 9.0 AMPS	340 lb.
SQR 4	48"L.X30"D.X50"H.	1/3 H.P.	115V/1/60HZ/10.0 AMPS	420 lb.
SQR 5	60"L.X30"D.X50"H.	1/2 H.P.	115V/1/60HZ/12.0 AMPS	540 lb.
SQR 6	72"L.X30"D.X50"H.	1/2 H.P.	115V/1/60HZ/13.0 AMPS	620 lb.
SQR 8	96"L.X30"D.X50"H.	3/4 H.P.	115V/1/60HZ/16.0 AMPS	880 lb.

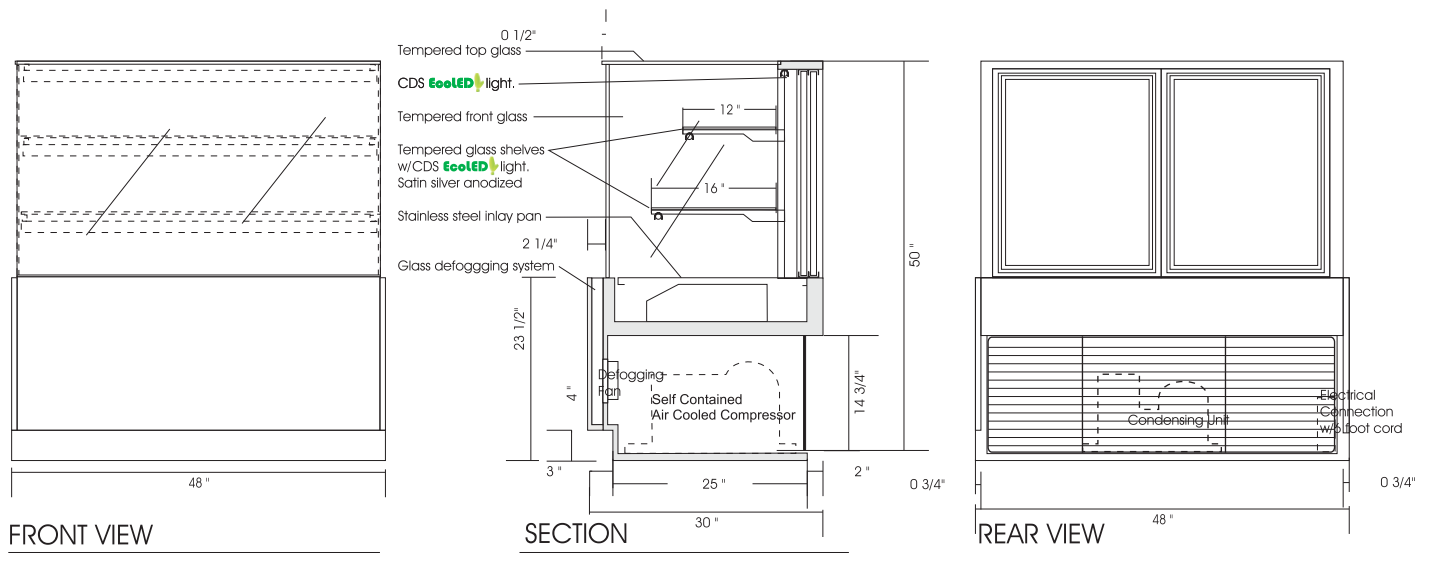

Operating temperature of 2° to 4° Celsius (37° to 40°F.) under normal store conditions of 24°C (75°F.) with 50% relative humidity. Condensation on glass may occur under hot & humid conditions. Product entering the display case must be 4°Celsius (40°F) or lower.

* Due to constant improvements, specifications are subject to change without notice.



Canadian Display Systems Inc.
 1-800-895-5862 (Toll Free)
cds1@on.aibn.com
www.canadiandisplayystems.com

